

Foster Series



- ▶ The design of the whole range based on an oval consisting of two circles
- ▶ Filigree, functional design
- ▶ Washbasins available in 550-750 mm and handrinse basin 470 mm, also suitable for small bathrooms
- ▶ Full range: Sanitary ceramics, accessories and bathroom furniture (→ see Badmagazin)
- ▶ The co-ordinating tap range Uno Zero is available from Hansgrohe
- ▶ Designed by: Norman Foster

Colour group	A			B			C
Colour / ref. of colour	White - 00	Manhattan - 11	Amber - 41	Pergamon - 47	Greenwich - 52	Key West - 56	Edelweiss - 78
available	●						

MM > INCHES

mm > inches							
5	$\frac{1}{8}$	295	$11 \frac{5}{8}$	585	23	880	$34 \frac{5}{8}$
10	$\frac{3}{8}$	300	$11 \frac{3}{16}$	590	$23 \frac{1}{4}$	885	$34 \frac{7}{8}$
15	$\frac{5}{8}$	305	12	595	$23 \frac{3}{8}$	890	35
20	$\frac{3}{4}$	310	$12 \frac{1}{4}$	600	$23 \frac{5}{8}$	895	$35 \frac{1}{4}$
25	1	315	$12 \frac{3}{8}$	605	$23 \frac{3}{4}$	900	$35 \frac{1}{2}$
30	$1 \frac{1}{8}$	320	$12 \frac{5}{8}$	610	24	915	36
35	$1 \frac{3}{8}$	325	$12 \frac{3}{4}$	615	$24 \frac{1}{4}$	920	$36 \frac{1}{4}$
40	$1 \frac{5}{8}$	330	13	620	$24 \frac{1}{2}$	925	$36 \frac{3}{8}$
45	$1 \frac{3}{4}$	335	$13 \frac{1}{4}$	625	$24 \frac{5}{8}$	935	$36 \frac{3}{4}$
50	2	340	$13 \frac{3}{8}$	630	$24 \frac{3}{4}$	940	37
55	$2 \frac{1}{8}$	345	$13 \frac{5}{8}$	635	25	980	$38 \frac{5}{8}$
60	$2 \frac{3}{8}$	350	$13 \frac{3}{4}$	640	$25 \frac{1}{4}$	995	$39 \frac{1}{8}$
65	$2 \frac{1}{2}$	355	14	645	$25 \frac{3}{8}$	1000	$39 \frac{3}{8}$
70	$2 \frac{3}{4}$	360	$14 \frac{1}{8}$	650	$25 \frac{5}{8}$	1015	40
75	3	365	$14 \frac{3}{8}$	655	$25 \frac{3}{4}$	1020	$40 \frac{1}{8}$
80	$3 \frac{1}{8}$	370	$14 \frac{1}{2}$	660	26	1030	$40 \frac{1}{2}$
85	$3 \frac{3}{8}$	375	$14 \frac{3}{4}$	665	$26 \frac{1}{4}$	1035	$40 \frac{3}{4}$
90	$3 \frac{1}{2}$	380	15	670	$26 \frac{3}{8}$	1045	$41 \frac{1}{8}$
95	$3 \frac{3}{4}$	385	$15 \frac{1}{8}$	675	$26 \frac{5}{8}$	1050	$41 \frac{3}{8}$
100	4	390	$15 \frac{3}{8}$	680	$26 \frac{3}{4}$	1070	$42 \frac{1}{8}$
105	$4 \frac{1}{8}$	395	$15 \frac{1}{2}$	685	27	1100	$43 \frac{1}{4}$
110	$4 \frac{3}{8}$	400	$15 \frac{3}{4}$	690	$27 \frac{1}{8}$	1150	$45 \frac{1}{4}$
115	$4 \frac{1}{2}$	405	16	695	$27 \frac{3}{8}$	1195	47
120	$4 \frac{3}{4}$	410	$16 \frac{1}{8}$	700	$27 \frac{1}{2}$	1200	$47 \frac{1}{4}$
125	$4 \frac{7}{8}$	415	$16 \frac{3}{8}$	705	$27 \frac{3}{4}$	1220	48
130	$5 \frac{1}{8}$	420	$16 \frac{1}{2}$	710	28	1225	$48 \frac{1}{4}$
135	$5 \frac{3}{8}$	425	$16 \frac{3}{4}$	715	$28 \frac{1}{8}$	1240	$48 \frac{7}{8}$
140	$5 \frac{1}{2}$	430	$16 \frac{7}{8}$	720	$28 \frac{3}{8}$	1300	$51 \frac{1}{8}$
145	$5 \frac{3}{4}$	435	$17 \frac{1}{8}$	725	$28 \frac{1}{2}$	1320	52
150	$5 \frac{7}{8}$	440	$17 \frac{3}{8}$	730	$28 \frac{3}{4}$	1400	$55 \frac{1}{8}$
155	$6 \frac{1}{8}$	445	$17 \frac{1}{2}$	735	$28 \frac{7}{8}$	1415	$55 \frac{1}{4}$
160	$6 \frac{1}{4}$	450	$17 \frac{3}{4}$	740	$29 \frac{1}{8}$	1515	$59 \frac{5}{8}$
165	$6 \frac{1}{2}$	455	$17 \frac{7}{8}$	745	$28 \frac{3}{8}$	1600	63
170	$6 \frac{3}{4}$	460	$18 \frac{1}{8}$	750	$29 \frac{1}{2}$	2000	$78 \frac{3}{4}$
175	$6 \frac{7}{8}$	465	$18 \frac{1}{4}$	755	$29 \frac{3}{4}$	2015	$79 \frac{3}{8}$
180	$7 \frac{1}{8}$	470	$18 \frac{1}{2}$	760	$29 \frac{7}{8}$	2500	$98 \frac{1}{2}$
185	$7 \frac{1}{4}$	475	$18 \frac{3}{4}$	765	$30 \frac{1}{8}$		
190	$7 \frac{1}{2}$	480	$18 \frac{7}{8}$	770	$30 \frac{3}{8}$		
195	$7 \frac{5}{8}$	485	$19 \frac{1}{8}$	775	$30 \frac{1}{2}$		
200	$7 \frac{7}{8}$	490	$19 \frac{1}{4}$	780	$30 \frac{3}{4}$		
205	$8 \frac{1}{8}$	495	$19 \frac{1}{2}$	785	$30 \frac{7}{8}$		
210	$8 \frac{1}{4}$	500	$19 \frac{5}{8}$	790	$31 \frac{1}{8}$		
215	$8 \frac{1}{2}$	505	$19 \frac{7}{8}$	795	$31 \frac{1}{4}$		
220	$8 \frac{5}{8}$	510	$20 \frac{1}{8}$	800	$31 \frac{1}{2}$		
225	$8 \frac{7}{8}$	515	$20 \frac{1}{4}$	805	$31 \frac{3}{4}$		
230	9	520	$20 \frac{1}{2}$	810	$31 \frac{7}{8}$		
235	$9 \frac{1}{4}$	525	$20 \frac{5}{8}$	815	$32 \frac{1}{8}$		
240	$9 \frac{1}{2}$	530	$20 \frac{7}{8}$	820	$32 \frac{1}{4}$		
245	$9 \frac{5}{8}$	535	21	825	$32 \frac{1}{2}$		
250	$9 \frac{7}{8}$	540	$21 \frac{1}{4}$	835	$32 \frac{7}{8}$		
255	10	545	$21 \frac{1}{2}$	840	$33 \frac{1}{8}$		
260	$10 \frac{1}{4}$	550	$21 \frac{5}{8}$	845	$33 \frac{1}{4}$		
265	$10 \frac{3}{8}$	555	$21 \frac{7}{8}$	850	$33 \frac{1}{2}$		
270	$10 \frac{5}{8}$	560	22	855	$33 \frac{5}{8}$		
275	$10 \frac{7}{8}$	565	$22 \frac{1}{4}$	860	$33 \frac{7}{8}$		
280	11	570	$22 \frac{1}{2}$	865	34		
285	$11 \frac{1}{4}$	575	$22 \frac{5}{8}$	870	$34 \frac{1}{4}$		
290	$11 \frac{3}{8}$	580	$22 \frac{7}{8}$	875	$34 \frac{1}{2}$		



INTERNATIONAL STANDARDS

EU STANDARDS

	Serie	Description	Model-No.	KIWA	IAPMO	QAS	CSA	Singapore	
International Standards P = Pending ● = Listed	■ 1930	Cistern	087220..03			●			
		Cistern, US version	087223..01		●				
		Toilet, floor st., vertical outlet	022701..00				●		●
			Toilet, floor st., horiz. outlet	022709..00			●		
			Toilet, US version	015101..00		●			
			Toilet, wall-mounted	018209..00					●
		■ Architec	Toilet, wall-mounted	019009..00	●		●		
			Washbasin	044958..00		●			
		■ Bacino	Washbowl	032542..00		●		●	
		■ Caro	Cistern	087250..01					●
			Toilet floor-st., Vario outlet	022509..00					●
			Toilet, wall-mounted	015609..00		●			
		■ Darling	Cistern	872600..01	●		●		
			Cistern, Singapore standard	872620..01					●
			Toilet, floor-st., vertical outlet	023201..00	●		●		●
			Toilet, floor-st., horiz. outlet	023209..00	●		●		●
			Toilet, wall-mounted	020709..00		●	●	●	
		■ Dellarco	Cistern	087301..01					●
			Cistern, Singapore standard	087321..00					●
			Toilet, floor-st., horiz. outlet	015009..00			●		
			Toilet, floor-st., vertical outlet	021801..00					●
			Toilet, floor-st., horiz. outlet	021809..00					●
		■ Duraplus	Cistern	087920..01	●		●		
			Cistern	088630..01			●		
			Cistern NL standard	087922..02	●				
			Cistern, Singapore standard	087924..01					●
			Toilet, wall-mounted	022809..00			●		
			Toilet, floor-st., vertical outlet	022901..00	●		●		●
			Toilet, floor-st., horiz. outlet	022909..00	●		●		
			Toilet, floor-st., Vario outlet	022409..00			●		
			Toilet, floor-st., Vario, washout	024609..00			●		
			Toilet, wall-mounted	019209..00			●		
			Toilet, wall-mounted	254709..00					●
		■ Foster	Cistern	091200..00			●		
			Toilet, wall-mounted, washout	017509..00		●	●	●	P
			Toilet, floor-st., vertical outlet	017609..00			●		P
		■ Giamo	Cistern	088200..01					●
			Toilet, floor-st., Vario outlet	024209..00					●
			Toilet, wall-mounted	019109..00					●
		■ Giorno	Cistern	0911000001		P			P
			Toilet, wall-mounted, washout	017309..00		●		●	
			Toilet, floor-st., Vario outlet	024709..00		P		P	
		■ Happy D.	Cistern	091000..01			●		
			Toilet, floor-st., horiz. outlet	017009..00		P	●		
			Toilet, wall-mounted	017109..00		●		●	
			Toilet, floor-st., Vario outlet	017009..00			●		
		■ Katya	Toilet, wall-mounted	018409..00	●				●
	■ Metro	Toilet, one piece US version	015701..01		●		●		
	■ Starck 2	Cistern, British standard	872900..01			●			
		Toilet, floor-st., Vario outlet	023809..00			●			
		Toilet, wall-mounted	016009..00		●		●		
		Toilet, one piece US version	016301..01		●		●		
	■ Starck 3	Cistern, British standard	092000..01	P		P			
		Toilet, floor-st., horiz. outlet	012409..00			P			
		Toilet, cl.-coup., Vario outlet	012809..00			P			
		Toilet, wall-mount., washdown	220009..00	P	P	P	P		
		Toilet, wall-mount., compact	220209..00	P		P			
		Toilet, cl.-coup., vertical outlet	012601..00	P		P			
		Toilet, cl.-coup., horiz. outlet	012609..00	P		P			
		Vanity basin	030549..00		●		●		
	■ Tribeca	Toilet, one piece US version	015901..01		●		●		
	■ Urinals	Urinal, waterless	084436..00		●	P			
		Urinal, electronic	083035..00		P	P			
	■ Vero	Washbasin	045460..00		●		●		
EU Standards				Dimension	Function				
		Washbasin		EN 31					
		Washbasin		EN 32					
		Handrinse basin		EN 111					
		Wall mounted toilet, close-coupled, with cistern		EN 34	EN 997				
		Wall mounted toilet for concealed cistern		EN 38	EN 997				
		Floor-standing toilet, close-coupled, with cistern		EN 33	EN 997				
		Floor-standing toilet for independent water supply		EN 37	EN 997				
		Urinal		EN 80	DIN 1390				
		Floor-standing bidet		EN 35					
		Wall-mounted bidet		EN 36					



Design: Norman Foster



GB Washbasin

F Lavabo

NL Wastafel

I Lavabo

E Lavabo # 0419550000/0419600000/0419700000

21 5/8 / 23 5/8 / 27 1/2 inches
 ← 550/600/700 mm →

Technical Data	
#	0419550000/0419600000/0419700000
Tap holes	→ Page 1-5 ○ ● ○
mm	550 x 445/600 x 490/700 x 530
kg	12,9/15,0/19,0
Accessories	Pedestal · Colonne · Zuil · Colonna · Pedestal, # 0863980000 Siphon cover · Cache-siphon · Sifonkap · Semicolonna · Semipedestal, # 0863970000
Installation	2 bolts · goujons · schroeven · bulloni · tornillos, 10 x 140 mm
Colour	00

mm	A	B	C	D	E	F	G
550	550	445	170	220	45	620	570
600	600	490	165	250	50	620	570
700	700	530	185	235	45	610	560

Technical Drawing		Scale 1 : 20
<p># 0419600000</p>		
<p>X To determine height please set washbasin on pedestal.</p>		

Design: Norman Foster



- GB** Handrinse basin
- F** Lave-mains
- NL** Handwasbakje
- I** Lavamani
- E** Lavamanos # 0419470000

18 1/2 inches
 ← 470 mm →

Technical Data	
#	0419470000
Tap holes	→ Page 1-5 ●
mm	470 x 390
kg	7,5
Accessories	Siphon cover · Cache-siphon · Sifonkap · Semicolonna · Semipedestal, # 0863990000
Installation	2 bolts · goujons · schroeven · bulloni · tornillos, 10 x 140 mm
Colour	00

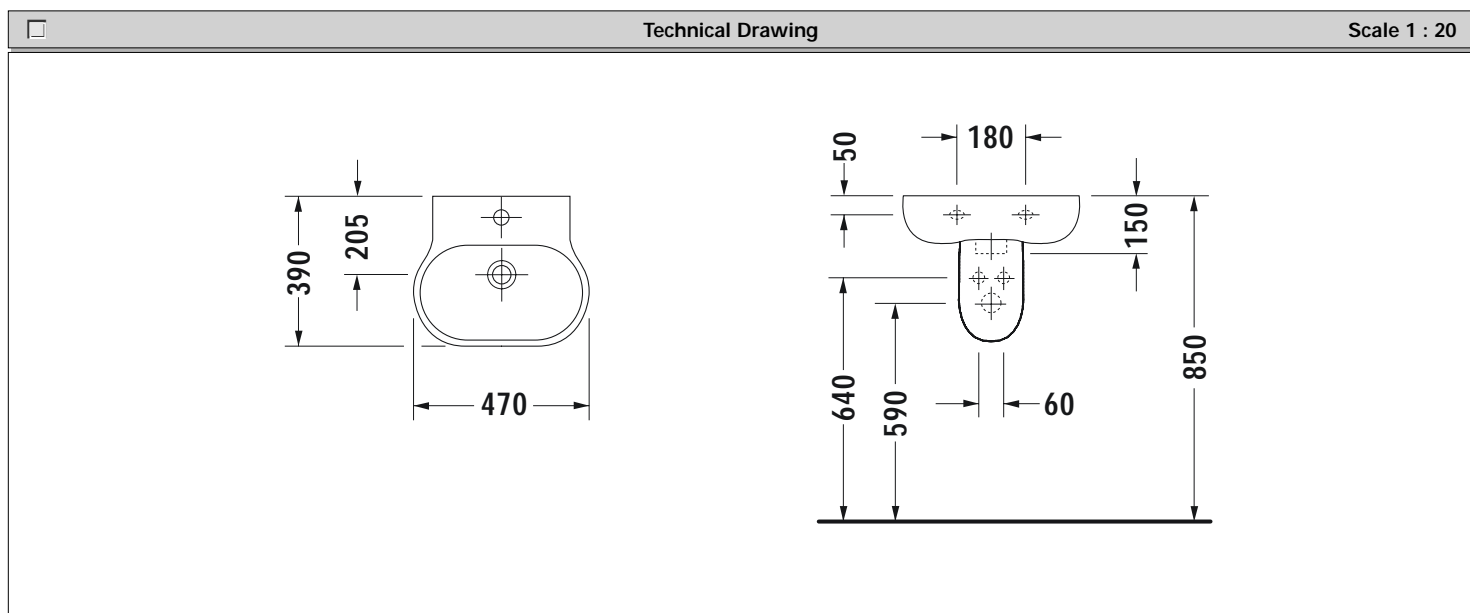

Design: Norman Foster



GB Pedestal
 F Colonne
 NL Zuil
 I Colonna
 E Pedestal # 0863980000



Siphon cover
 Cache-siphon
 Sifonkap
 Semicolonna
 Semipedestal #0863970000 / 0863990000

Technical Data	
#	0863980000
	for washbasin · pour lavabo · voor wastafel · per lavabo · para lavabo, # 0419550000/0419600000/0419700000
kg	12,3
Colour	00

Technical Data	
#	0863970000 / 0863990000
	→ # 0863970000 for washbasin · pour lavabo · voor wastafel · per lavabo · para lavabo, # 0419550000/0419600000/0419700000
	→ # 086399..00 for handrinsebasin · lave-mains · handwasbak · lavamani · lavamanos, # 0419470000
kg	5,0/4,7
Installation	# 0055030000
Colour	00

Design: Norman Foster



- GB Wall-mounted bidet
- F Bidet suspendu
- NL Wandbidet
- I Bidet sospeso
- E Bidé suspendido # 0134150000

Technical Data	
#	0134150000
Tap holes	→ Page 1-5 ●
kg	15,0
Installation	# 0065001000
Colours	00

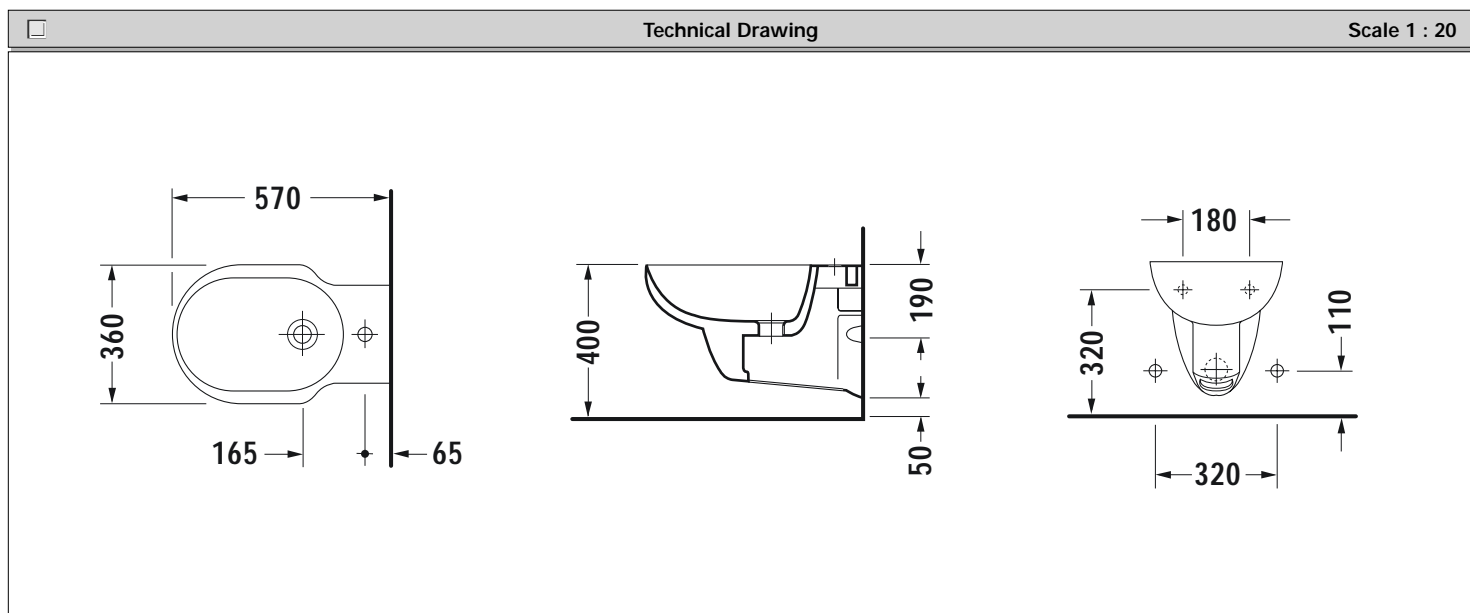

Design: Norman Foster



- GB** Floor standing bidet
- F** Bidet sur pied
- NL** Staand bidet
- I** Bidet a pavimento
- E** Bidé de pie # 0134100000

Technical Data	
#	0134100000
Tap holes	→ Page 1-5 ●
kg	18,0
Installation	inclusive · inclus · inclusief · incluso · incluida
Colours	00

Technical Drawing		Scale 1 : 20
<p>Technical drawing showing three views of the bidet with dimensions:</p> <ul style="list-style-type: none"> Top View: Overall width 570, depth 360, distance from front edge to center of tap holes 170, and distance from center of tap holes to side wall 65. Side Profile View: Total height 400, and height from floor to top of the bidet body 215. Front View: Distance from floor to center of tap holes 110, distance from floor to top of the bidet body 160, and distance from center of tap holes to side wall 80. 		

Design: Norman Foster

US Version
IAPMO listed

- GB** Wall-mounted toilet
 F Cuvette suspendue
 NL Wand-WC
 I Vaso sospeso
 E Inodoro suspendido # 0175090000

Technical Data	
#	0175090000
<ul style="list-style-type: none"> ◆ Washdown toilet · Cuvette à fond creux · Diepspoel-WC · Vaso a cacciata · Inodoro de lavado inferior 	
kg	16,0
Accessories	Toilet seat and cover · Abattant · WC-zitting · Sedile · Asiento y tapa, # 0060210000 Noise reduction gasket · Set de protection acoustique · Geluiddemping-set · Set insonorizzante per tutti i vasi sospesi · Junta para reducción de ruido, # 0050200000

Technical Data	
Installation	# 006500**00
Installation kit	# 001432**00
Info	** 00 – White · Blanc · Wit · Bianco · Blanco ** 10 – Chrome · Chromé · Chroom · Cromato · Cromado
Colour	00

Technical Drawing		Scale 1 : 20

Design: Norman Foster



- GB** Floor standing toilet
F Cuvette sur pied
NL Staand WC
I Vaso a pavimento
E Inodoro # 0177090000

Technical Data	
#	0177090000
	<ul style="list-style-type: none"> ◆ Washdown toilet, for independent water supply · Cuvette à fond creux · Diepspoel-WC · Vaso a cacciata, per entrata dell'acqua libera · Inodoro de lavado inferior Horizontal outlet · Sortie horizontale · Horizontale afvoer · Scarico a parete · Desagüe horizontal
kg	20,0
Accessories	Toilet seat and cover · Abattant · WC-zitting · Sedile · Asiento y tapa, # 0060210000
Installation	inclusive · inclus · inclusief · incluso · incluida
Colours	00

	A	Z
Flushometer · Robinet de chasse d'eau · Drukspoelsysteem · Pulsante di risciacquo · Fluxometro	185	150
Concealed cistern · Réservoir caché · Reservoir verborgen · Cassetta nascosta · Cisterna oculta	135	100
Cistern · Réservoir · Reservoir · Cassetta di sciacquo esterna · Cisterna	255	220

Technical Drawing		Scale 1 : 20

Design: Norman Foster



- GB** Floor standing toilet
F Cuvette sur pied
NL Staand WC
I Vaso a pavimento
E Inodoro **Vario # 0176090000**

Technical Data	
#	0176090000
	Washdown toilet · Cuvette à fond creux · Diepspoel-WC · Vaso a cacciata · Inodoro de lavado inferior Horizontal outlet · Sortie horizontale · Horizontale afvoer · Scarico a parete · Desagüe horizontal
kg	21,5
Accessories	Cistern · Réservoir · Reservoir · Cassetta · Cisterna, # 0912000001/0912100001 Toilet seat and cover · Abattant · WC-zitting · Sedile · Asiento y tapa, # 0060210000
Installation	inclusive · inclus · inclusief · incluso · incluida

Technical Data	
Info	Vario outlet set · Set de raccordement universel Vario · Vario-set voor universele aansluiting · Completo di allacciamento Vario · Surtido de conexión Vario, # 0014220000 Special connector for vertical outlet · Afvoer buis speciaal voor vertikale aansluiting · Tubo d'uscita speciale per allacciamento verticale · Tubo de desagüe especial para salida vertical, # 8990250006 With universal outlet horizontal/vertical · Avec sortie universelle horizontale/verticale · Met universele afvoer voor horizontale/verticale aansluiting · Con scarico universale per allacciamento orizzontale/verticale · Con surtido universal horizontal/vertical
Colours	00

Technical Drawing		Scale 1 : 20

Design: Norman Foster



- GB Cistern
 F Réservoir
 NL Reservoir
 I Cassetta
 E Cisterna # 0912000001/0912100001

Technical Data	
#	0912000001/0912100001
◆ # 0912000001	Back or side supply · Alimentation latérale ou arrière · Aansluiting links/rechts en midden · Per attacco sinistro, destro o centrale · Suministro de agua por la parte posterior o lateral
◆ # 0912100001	Bottom supply · Alimentation par dessous · Aansluiting onder links · Per attacco sinistro basso · Suministro de agua por la parte inferior
	With mechanism chrome · Avec mécanisme chromé · Met chroom mechanisme · Con batteria cromata · Mecanismo cromado

Technical Data	
kg	11,5/11,5
Accessories	→ # 0912000001 Conversion set for back supply · Set de transformation pour alimentation arrière · Aanpassingsset om van achteraansluiting naar zijdelingse te veranderen · Set per allacciamento successivo per attacco centrale · Surtido para conversión centrada, # 0075001000
Colour	00

Technical Drawing		Scale 1 : 20



Design: Norman Foster

**GB** Toilet seat and cover**F** Abattant**NL** WC-zitting**I** Sedile**E** Asiento y tapa # 0060210000

Technical Data	
#	0060210000
kg	2,8
Info	Hinges · Charnières · Scharnieren · Cerniere · Bisagras: Stainless steel · inox · edelstaal · inox · acero inoxidable
Colour	00